

LOVOL



LOVOL [lovol.global](https://www.lovolglobal.com) LOVOL

WEICHAI LOVOL HEAVY INDUSTRY CO., LTD.

Add: No.192 S Beihai Road, Weifang, Shandong, China. PC: 261206 Tel: +86-536-7527358

Website: www.lovolglobal.com E-mail: lovol_agriexport@global.lovol.com

Due to real-time changes involving product batches, production and supply factors, in order to provide accurate product information, specifications, and features, LOVOL may make real-time adjustments to text descriptions and images in the brochure, so that they match the product performance, specifications, indexes, and components of the actual product. Product information is subject to such changes and adjustments without notice.

LOVOL

LOVOL TRACTOR
STAGE V







PRODUCT CATALOGUE

04 / 05 COMPANY PROFILE

06 / 07 BUSINESS SECTIONS

08 / 09 TRACTOR M254

10 / 11 TRACTOR M404

12 / 13 TRACTOR M504

16 / 17 TRACTOR M754

18 / 19 TRACTOR P4110

20 / 21 TRACTOR P5130

22 / 23 TRACTOR P7000

COMPANY PROFILE

LOVOL (Weichai Lovol Heavy Industry Co., Ltd.) founded in 1998, is a world's leading mechanical equipment industry group. Based on the intelligent equipment industry, Lovol leads the industrial innovation and development in the fields of agricultural equipment, construction machinery, vehicles, finance and network technology. Possess a complete industry chain of core components

As the witness and the leader of China's agricultural equipment industry, Lovol is the only independent brand in China that can provide an overall mechanization solution for modern agriculture. In 2020, the brand value of Lovol reached 74.358 billion RMB, ranking 74th among "China's 500 most valuable brands".

Weichai Lovol has nearly 3000 dealers in global marketing network, with businesses in more than 120 countries and regions. Lovol has ranked No. 1 in export for 20 years.



Providing Intelligent Technology Complete Solutions For Modern Agribusiness



SHANDONG HEAVY INDUSTRY: AN INFLUENTIAL GLOBAL INDUSTRIAL EQUIPMENT MULTINATIONAL GROUP.

Operating income: 500 billion RMB; Global employees: 140,000; Total assets: 367 billion RMB.



WEICHAI
潍柴



陕汽重卡

LOVOL

SHANTUI

中通客车
ZHONG TONG BUS

FAST GEAR

KION
GROUP

Linde

FERRETTIGROUP

汉德车桥

DEMATIC

MACTELPSI
Baudouin

BALLARD

PSI

CeresPower

BUSINESS SECTIONS

LOVOL belongs to Weichai group which is one part of Shandong Heavy Industry Group, the group business covers seven sectors: power systems, commercial vehicles, construction machinery, intelligent logistics, agricultural equipment, luxury yachts, finance and services.

power system

Commercial vehicle

Construction machinery

Smart logistics

Agricultural equipment

luxury yachts

Finance and Service



OVERSEAS MARKET EXPANSION

Business Footprint

120+
countries and regions

Channels Established

500+

Cumulative Sales of Various
Types of Machines

200,000+
units

Representative Product

The export market share of large and medium-sized tractors is **28%**, ranking **first** in the domestic agricultural machinery industry for 17 years in a row.

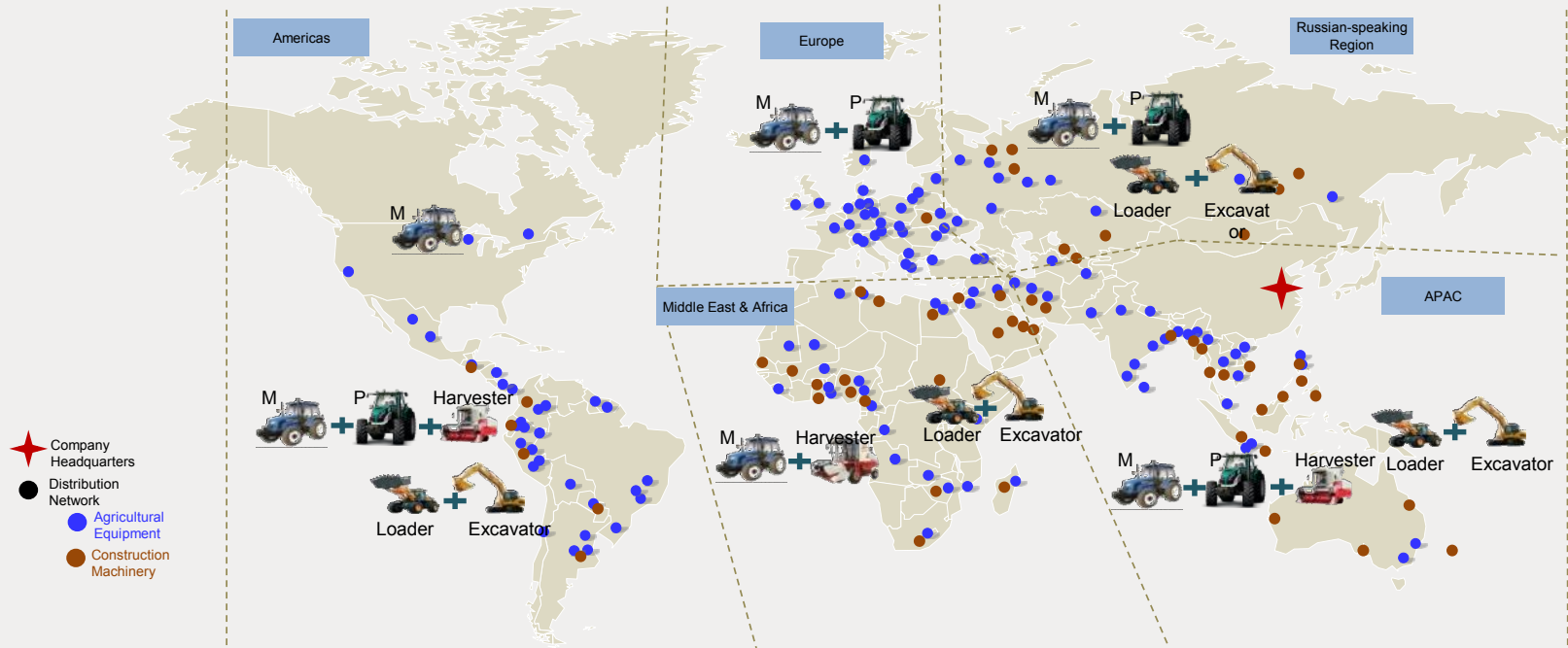

GLOBAL SERVICE AND SPARE PARTS GUARANTEE

The company has always been committed to building a "professional, fast and thoughtful" customer service guarantee system. Adhering to the "customer-centered" service concept, provides global users with "one-stop" service guarantee in the whole process of pre-sale, in-sales and after-sales by means of service outsourcing, spare parts supply guarantee, service skill training and service engineering data development.

- Over 1000 authorized service parts network all over the world ;
- Over 2000 authorized service professional team ;
- 85 kinds of service technical data query support ;
- More than 50 million US dollars spare parts reserve, 100% genuine parts guarantee ;
- 5 global training bases, more than 100 training aids.



SMART AGRICULTURE EXPLORATION

Smart Agricultural Solutions -- Develop and operate a smart agriculture platform based on smart terminal operations

iFarming
SOLUTIONS

iFarming
SOLUTIONS

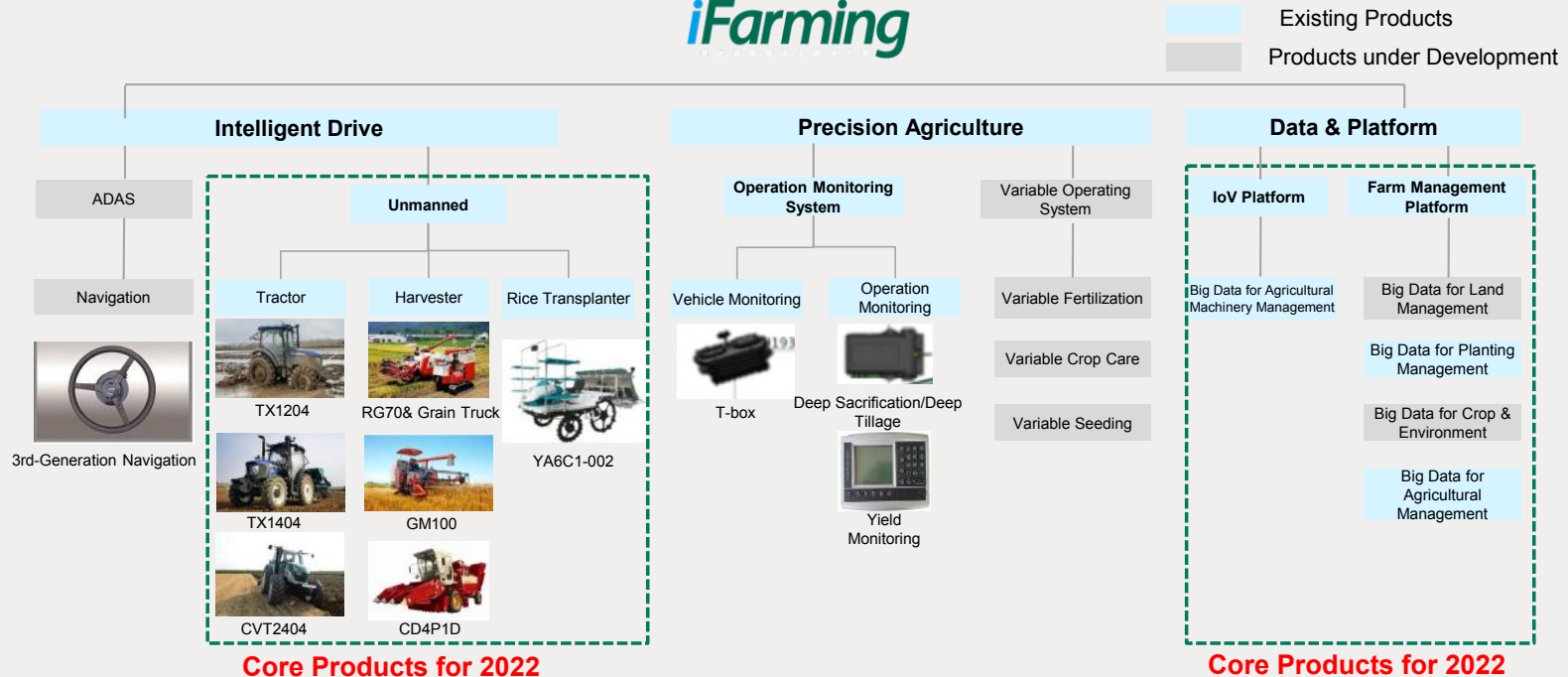

FUTURE STRATEGY AND GOALS

In the next 5-10 years, focusing on smart agricultural machinery and smart agriculture, Weichai Lovol Heavy Industry will continue to increase input in technological innovation, and open and integrate resources. Based on leading the way in the Chinese market, it strives to make major breakthroughs in overseas strategic markets, thus building itself into a leading global brand in the smart agricultural technology industry. The company expects to secure RMB 35 billion in revenue by 2025 and RMB 200 billion by 2030.

A Leading Global Brand in the Smart Agricultural Technology Industry

Smart
Agricultural
Machinery

By 2025---RMB 30 billion, world No. 5
By 2030---RMB 80 billion, world No. 3



Smart
Agriculture

By 2025---RMB 5 billion
By 2030---RMB 120 billion



Tractor M254 (25HP)

STAGE V

LOVOL M254 is versatile in various demands with modern appearance design. Its strong powertrain allows it to have the excellent performance of the material handling, small farm jobs, transportation. Optional cabin with heater allows the operator work comfortable in the cold weather.





Stage V Laidong engine

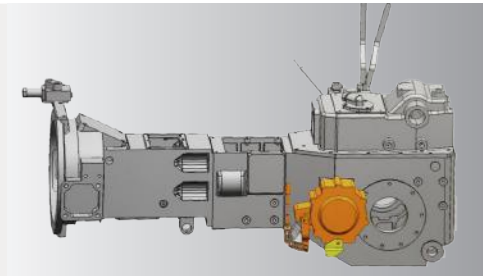

Reinforced powertrain

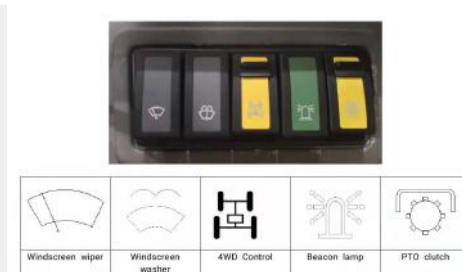
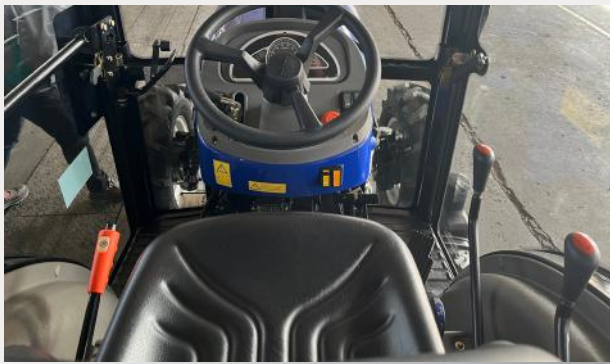
Electro Hydraulic Control
4WD and PTO

Ergonomic design

Model		M254
ENGINE		
TYPE		Laidong KM385
DISPLACEMENT(L)/CYLINDERS/ASPIRATION		1.532/3/N
MAX.POWER (KW)		18.4
RATED SPEED (RPM)		2350
TRANSMISSION		
DRIVE TYPE		4 WD
NO.OF SPEEDS		Synchro shuttle 8F+8R
PTO		540/1000 Electronic Control
BRAKE		Oil immersed disc brake
DIMENSION & WEIGHT WITH STANDARD TIRES		
OVERALL SIZE (Length×width×height)	(MM)	3300x1550x2420(To Cab) 3245x1565x2610(To ROPS)
WHEELBASE	(MM)	1700
MAX.FRONT/REAR BALLAST	(KG)	80/112
WEIGHT(WITHOUT BALLAST)	(KG)	1594 (ROPS)/1703 (Cab)
FRONT TIRE		260/70R16
REAR TIRE		280/85R24

*synchronizer for shuttle

Tractor M404 (40HP)

STAGE V

LOVOL M404 is an ideal choice for multi-task utility machine, suspension pedals and ergonomic design handles make the driving easy and flexible, contribute to excellent performance in material handling, transportation, the reinforced powertrain allows LOVOL M404 work in the small farms and fruit garden. Optional cabin with heater allows the operator work comfortable in cold weather.





Stage V Doosan engine

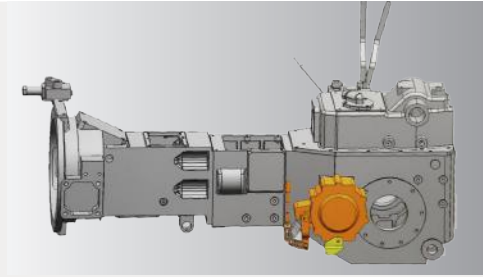

Reinforced powertrain

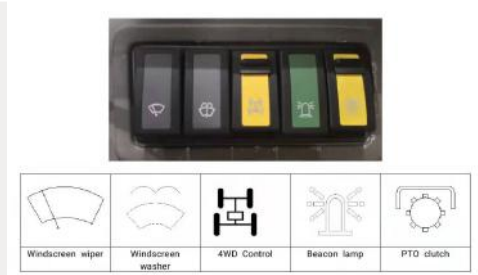

Electro Hydraulic Control
4WD and PTO



Ergonomic design

Model		M404
ENGINE		
TYPE		DOOSAN DM01
DISPLACEMENT(L)/CYLINDERS/ASPIRATION		1.794/3/T
MAX.POWER	(KW)	29.3
RATED SPEED	(RPM)	2350
TRANSMISSION		
DRIVE TYPE		4 WD
NO.OF SPEEDS		Synchro shuttle 8F+8R
PTO		540/1000 E-hydraulic Control
BRAKE		Oil immersed disc brake
DIMENSION & WEIGHT WITH STANDARD TIRES		
OVERALL SIZE (Length×width×height)	(MM)	3558×1550×2415(To Cab)/2450(To ROPS)
WHEELBASE	(MM)	1800
MAX.FRONT/REAR BALLAST	(KG)	80/112
WEIGHT(WITHOUT BALLAST)	(KG)	1715(Cab)/1624(ROPS)
FRONT TIRE		7.5-16,260/70R16
REAR TIRE		12.4-24 ,320/85R24

*synchronizer for shuttle

Tractor M504 (50HP)

STAGE V

LOVOL M504 is designed for a variety of tasks includes courtyard mowing, material handling, small farm tilling etc., it can work with a complete range of implements. The operation is easy and flexible with a strong powertrain, also easy to maintain with economy cost, which make it an ideal choice for farmers.





Stage V Doosan engine

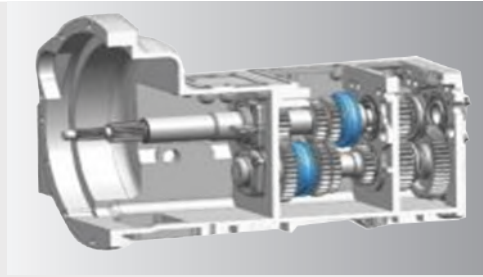

12+12 shuttle gears



Electro Hydraulic Control
4WD and PTO



Full view cabin with A/C

Model	M504
ENGINE	
TYPE	DOOSAN DM01
DISPLACEMENT(L)/CYLINDERS/ASPIRATION	1.794/3/T
MAX.POWER (KW)	36.9
RATED SPEED (RPM)	2400
TRANSMISSION	
DRIVE TYPE	4 WD
NO.OF SPEEDS	synchronizer 12F+12R with shuttle
PTO	540/1000 E-hydraulic Control
BRAKE	Oil immersed disc brake
DIMENSION & WEIGHT WITH STANDARD TIRES	
OVERALL SIZE (Length×width×height) (MM)	3986×1790×2842(To Cab)/2614(To ROPS)
WHEELBASE (MM)	1990
MAX.FRONT/REAR BALLAST (KG)	150/540
WEIGHT(WITHOUT BALLAST) (KG)	2535(Cab)/2355(ROPS)
FRONT TIRE	280/70R20
REAR TIRE	380/70R28

*synchronizer for main shifts

Tractor M654 (65HP)

STAGE V

LOVOL M654 is a medium size model for various types of tasks. It was designed to provide a better cost benefit to rural farmers, it has excellent performance of different kinds of applications such as material handling, municipal maintenance, transportation, even for the heavy duty apply like soil preparation.





Stage V Doosan engine

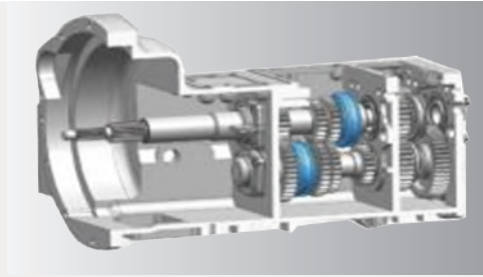

12+12 shuttle gears

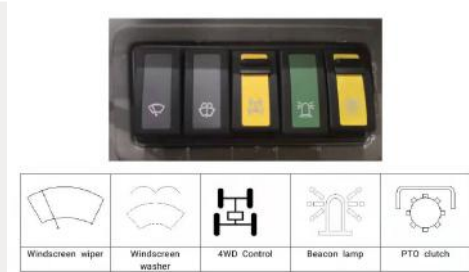

Electro Hydraulic Control
4WD and PTO



Full view cabin with A/C

Model		M654
ENGINE		
TYPE		DOOSAN DM02
DISPLACEMENT(L)/CYLINDERS/ASPIRATION		2.392/4/T
MAX.POWER (KW)		47.8
RATED SPEED (RPM)		2400
TRANSMISSION		
DRIVE TYPE		4 WD
NO.OF SPEEDS		Synchronizer 12F+12R with shuttle
PTO		540/1000 E-hydraulic Control
BRAKE		Oil immersed disc brake
DIMENSION & WEIGHT WITH STANDARD TIRES		
OVERALL SIZE (Length×width×height)	(MM)	4105×1830×2910(To Cab) /2678 (To ROPS)
WHEELBASE	(MM)	2070
MAX.FRONT/REAR BALLAST	(KG)	150/540
WEIGHT(WITHOUT BALLAST)	(KG)	2940(Cab)/2780(ROPS)
FRONT TIRE		300/70R20
REAR TIRE		380/85R30

*synchronizer for main shifts

Tractor M754 (75HP)

STAGE V

LOVOL M754 is designed for comfort and easy operation. Cabin with A/C allows the operator has an excellent view and comfortable environment, operation handles with ergonomic design make the drive easy and flexible. The strong powertrain enable M754 can meet with utility jobs, transportation, and farming jobs.





Stage V Doosan engine

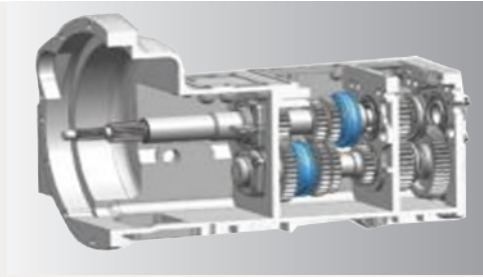

12+12 shuttle gears



Electro Hydraulic Control
4WD and PTO



Full view cabin with A/C

Model		M754
ENGINE		
TYPE		DOOSAN DM02
DISPLACEMENT(L)/CYLINDERS/ASPIRATION		2.392/4/T
MAX.POWER (KW)		55.1
RATED SPEED (RPM)		2400
TRANSMISSION		
DRIVE TYPE		4 WD
NO.OF SPEEDS		Synchronizer 12F+12R with shuttle
PTO		540/1000 Electronic Control
BRAKE		Oil immersed disc brake
DIMENSION & WEIGHT WITH STANDARD TIRES		
OVERALL SIZE (Length×width×height)	(MM)	4105×1830×2910(To Cab) /2678 (To ROPS)
WHEELBASE	(MM)	2070
MAX.FRONT/REAR BALLAST	(KG)	150/540
WEIGHT(WITHOUT BALLAST)	(KG)	2740(Cab)/2980(ROPS)
FRONT TIRE		300/70R20
REAR TIRE		380/85R30

*synchronizer for main shifts

Tractor P4110 (110HP)

STAGE V

LOVOL P4110 equipped an intercooling turbo engine with high torque reservation, 18+18 creeper shifts plus synchro shuttle allow the tractor work with more speed choices, the shuttle shift enable it easier and more convenient for material handling and transportation job. The robust powertrain makes P4110 efficient face to farming jobs.



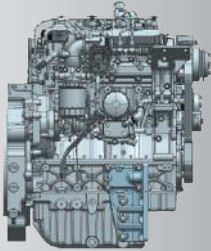

Stage V Doosan engine

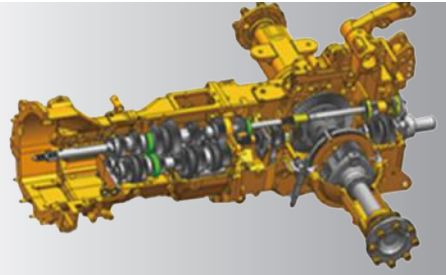

Optional Power shuttle transmission



High load capacity



Full view Cabin with A/C

Model		P4110
ENGINE		
TYPE		DOOSAN DN03
DISPLACEMENT(L)/CYLINDERS/ASPIRATION		3.4/4/T
MAX.POWER	(KW)	85.7
RATED SPEED	(RPM)	2400
TRANSMISSION		
DRIVE TYPE		4 WD
NO.OF SPEEDS		18F+18R creeper with synchronizer shuttle, optional power shuttle
PTO		540/1000 E-hydraulic control
BRAKE		Wet type disc brake
DIMENSION & WEIGHT WITH STANDARD TIRES		
OVERALL SIZE (Length×width×height)	(MM)	4725×2200×3185(To Alarm lamp)
WHEELBASE	(MM)	2370
MAX.FRONT/REAR BALLAST	(KG)	440/328
WEIGHT(WITHOUT BALLAST)	(KG)	3890(Cab)
FRONT TIRE		380/70R24
REAR TIRE		520/70R34

*synchronizer for main shifts

Tractor P5130 (130HP)

STAGE V

LOVOL P5000 equipped a reliable and efficient intercooling turbo engine, 45F+15R 3 range Semi-Powershift and Power-shuttle transmission make the gear change smooth and comfortable under a wide speed range. Cabin with A/C offers a panoramic view. P5000 is an ideal assistant to farmers for farming and transportation job.



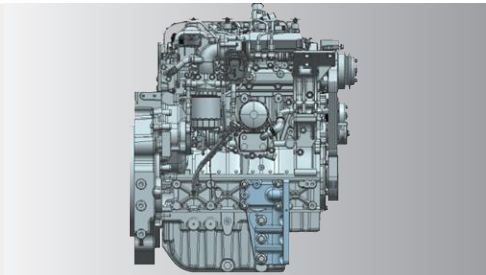

Stage V Doosan engine

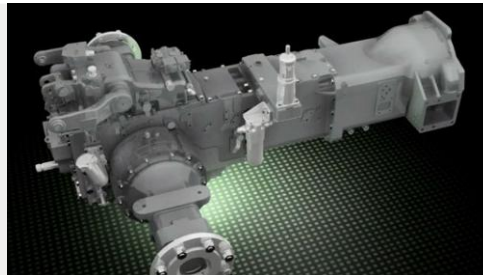

3-ranges powershift



High load capacity



Full view Cabin with A/C

Model		P5130
ENGINE		
TYPE		DOOSAN DN03
DISPLACEMENT(L)/CYLINDERS/ASPIRATION		3.4/4/T
MAX.POWER	(KW)	95.6
RATED SPEED	(RPM)	2200
TRANSMISSION		
DRIVE TYPE		4 WD
NO.OF SPEEDS		45F+15R 3-ranges powershift
PTO		540/1000 Electronic Control
BRAKE		Hydraulic assisted Oil immersed disc brake
DIMENSION & WEIGHT WITH STANDARD TIRES		
OVERALL SIZE (Length×width×height)	(MM)	4840×2250×2965(To Alarm lamp)
WHEELBASE	(MM)	2397
MAX.FRONT/REAR BALLAST	(KG)	480/420
WEIGHT(WITHOUT BALLAST)	(KG)	4690(Cab)
FRONT TIRE		380/70R28
REAR TIRE		520/70R38

Tractor P7000 (CVT)

LOVOL P7240 equipped a high torque reserve Weichai brand engine, the updated Cabin A/C offers a panoramic view, ergonomic design makes the operation easy and convenient. Full CVT transmission make P7000 an ideal choice to liberate the operator from huge operate job.





Weichai high efficiency engine

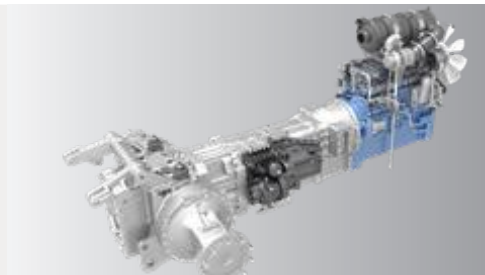

CVT Powertrain

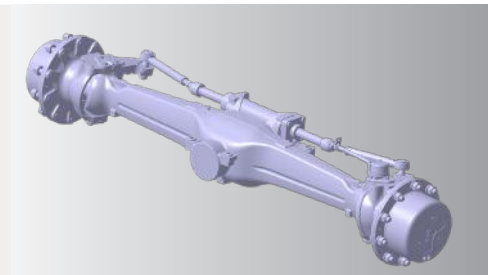

High load capacity



Smart control

Model	P7240
ENGINE	
TYPE	Weichai WP7
DISPLACEMENT(L)/CYLINDERS/ASPIRATION	7.47/6/T
MAX.POWER (KW)	176.5
RATED SPEED (RPM)	2200
TRANSMISSION	
DRIVE TYPE	4 WD
NO.OF SPEEDS	CVT
PTO	540/540E/1000 Electronic Control
BRAKE	Hydraulic assisted Oil immersed disc brake
DIMENSION & WEIGHT WITH STANDARD TIRES	
OVERALL SIZE (Length×width×height) (MM)	5620×2730×3120
WHEELBASE (MM)	2975
MAX.FRONT/REAR BALLAST (KG)	1120/0
WEIGHT(WITHOUT BALLAST) (KG)	8050(Cab)
FRONT TIRE	540/65 R30
REAR TIRE	650/65 R42